

Replacement of Perma-Door “U” Channel Door Bottom

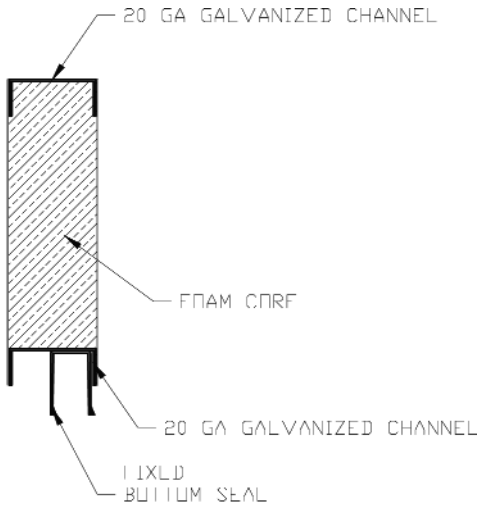

figure 1

> Background

Prior to the early 1990's, Perma-Door manufactured their steel edge entry door utilizing a 20 gauge galvanized bottom channel that was installed in the bottom of the slab in an inverted position (see figure 1). This channel accommodated a “U” shaped bottom seal that was installed via screws into the bottom of the door and would form a seal with the threshold preventing water and air from penetrating the interior of the home.

In the early 1990's when Perma-Door merged with Taylor Door, the old "U" channel type door bottom was eliminated from the product design. This type of sweep continued to be manufactured by other companies for several years but was eventually discontinued. In an effort to service customers who had purchased the old Perma-Door, Taylor Building Products maintained a supply of these sweeps but is quickly approaching the end of this stock.

> Solution

As we realize that many customers continue to be happy with the performance of their Perma-Door but may desire to replace the door bottom, Taylor Building Products is pleased to provide the following solution.

- 1) Readily available from most lumberyards, hardware stores or home centers, is an “L” shaped door bottom sweep. The estimated cost for this sweep is under \$10.00.
- 2) Remove old “U” channel door bottom either by carefully cutting away the old material or by removing the slab from the hinges, laying the unit on its side and unscrewing the old door bottom sweep.
- 3) Reinstall the slab on its hinges if it was removed in step 2.
- 4) Following the instructions provided by the new door bottom sweep's manufacturer, install the new door bottom sweep onto the bottom of the Perma-Door slab with the screws provided. (There may be the need to pre-drill the door slab.) Be sure that the new door bottom sweep comes into tight contact with the bottom of the door slab on the exterior of the door. (see figure 2)
- 5) If a gap is present between the exterior of the slab and the new door bottom sweep, a small bead of silicone may be applied to prevent water from penetrating the gap. It is also recommended that you apply a small bead of silicone onto both ends of the door bottom sweep where they meet the door slab to prevent water from entering this area.

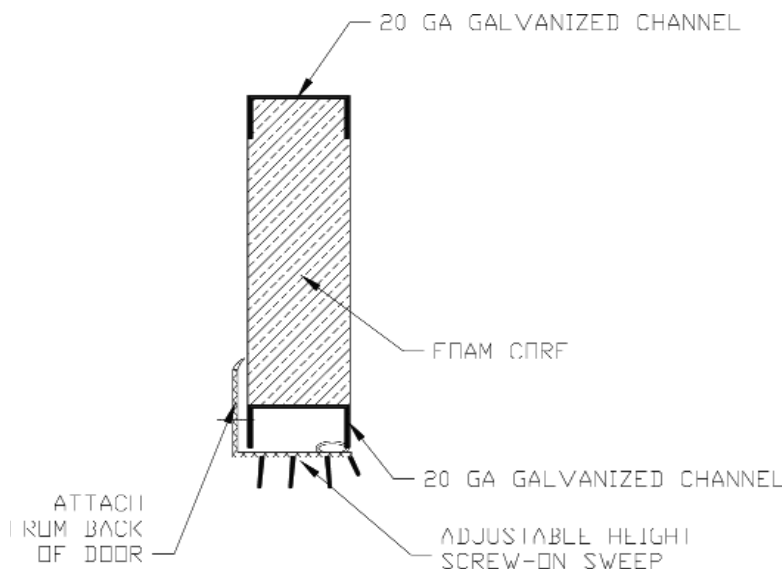

figure 2

6) To prevent excessive wearing of your new door bottom sweep and to ensure a proper seal, be sure to adjust the riser of your threshold. This can be done by either tightening (lowering) or loosening (raising) the adjustment screws on the riser. A properly adjusted riser should come into contact with the bottom sweep but not cause excessive binding or tearing of the door bottom sweep.

7) Estimated time for this correction is 15 to 30 minutes.